

OCEANAIRE

MODEL: OWC1211

1 TON DELUXE PORTABLE WATER-COOLED AC

TECHNICAL SPECIFICATIONS



WATER COOLED



WARRANTY

ALL OCEANAIRE PRODUCTS ARE COVERED BY THE OCEANAIRE LIMITED WARRANTY

1 YEAR ON THE FULL PRODUCT PLUS, 4 ADDITIONAL YEARS FOR THE COMPRESSOR (RESTRICTIONS APPLY)

COOLING CAPACITY	12,000 BTUH
VOLTAGE	115 V, 60 Hz, Single Phase
AMPS	8.1 A
WATTS	930 W
IN RUSH AMPS	56 A
EER	12.9
COMPRESSOR TYPE	ROTARY
COMPRESSOR MOTOR	1 HP
COMPRESSOR RLA	9.5 A
COMPRESSOR LRA	50 A
EVAPORATOR BLOWER	CENTRIFUGAL
EVAP CFM - HIGH	400
EVAP MOTOR HP	1/8 HP
EVAP MOTOR AMPS	1.2 A
CONDENSER	COAXIAL
COND GPM at EWT, 60°F	0.75 GPM
COND GPM at EWT, 85°F	3.0 GPM
POWER CORD	14/3
PLUG TYPE	5-15P, LCDI
CORD LENGTH	10 FT
CONDENSATE REMOVAL LIFT (VERTICAL)	PUMP-AUTOMATIC 20 FT
REFRIGERANT CHARGE	14 OZ., R-410A
HEIGHT W/ CASTERS	33-3/4 in
HEIGHT W/O CASTERS	28-1/2 in
WIDTH	28-1/8 in
DEPTH	13-1/8 in
NET WEIGHT	125 lb.

SPECIFICATIONS SUBJECT TO CHANGE WITHOUT NOTICE

- OA **Cooling Capacity** is total BTUH at 80°DB/67°WB return air, 95°F Outdoor at high fan speed
- OA Dedicated Circuit and Time Delay fuses/circuit breakers are recommended
- OA CFM with free discharge
- OA Amps & Watts at 115 Volts

COOLING AMBIENT OPERATING RANGE 65° TO 105°

NOT APPROVED FOR OUTDOOR USE



OA-TS-OWC1211-07262018

OCEANAIRE
OCEANAIRE-INC.COM



OCEANAIRE

TECHNICAL SPECIFICATIONS

MODEL: OWC1211
1 TON DELUXE PORTABLE
WATER-COOLED AC

FEATURES:

- OA SOLID STATE ELECTRONIC CONTROLLER
- OA AUTOMATIC 6-SPEED FAN CONTROL WITH MANUAL OVERRIDE
- OA LARGE LED DISPLAY
- OA SWIVEL BALL BEARING CASTERS WITH LOCKS AT FRONT
- OA INTERNAL CONDENSATE PUMP WITH OVERFLOW ALERT
- OA LCDI POWER CORD
- OA HIGH PRESSURE SAFETY SWITCH
- OA WASHABLE ELECTROSTATIC AIR FILTER

ACCESSORIES

NK-1 (2 x 4")
NOZZLE KIT

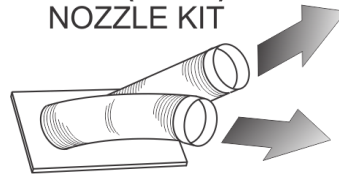

DDA-6
DISCHARGE
DUCT ADAPTER

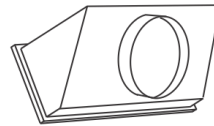

DEP-10
EVAPORATOR
RETURN AIR PLENUM

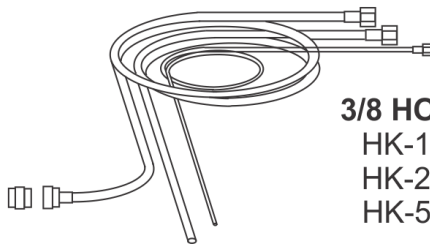
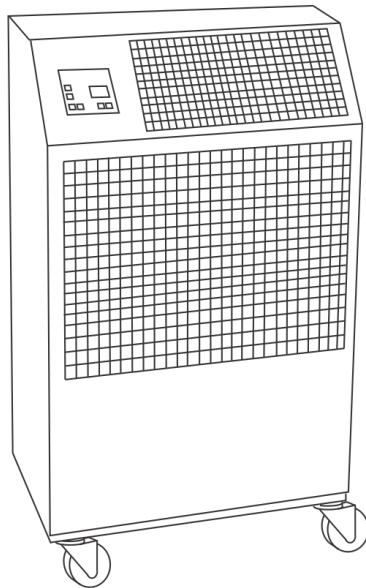
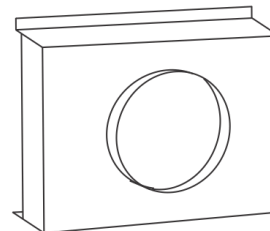

3/8 HOSE KIT

HK-1	10'
HK-2	25'
HK-5	40'

OCEANAIRE
OCEANAIRE-INC.COM

